

d1	l	d2	k
12	100	18	7.0
	125		
	160		
	200		
	250		
	315		
	400		
	500		
	630		
	800		
1000			
13	160	20	7.0
	200		
	250		
	315		
	315		
14	100	22	7.0
	125		
	160		
	200		
	250		
	315		
	400		
	500		
	630		
	800		
16	100	22	7.0
	125		
	160		
	200		
	250		
	315		
	400		
	500		
	630		
	800		
18	100	24	7.0
	125		
	160		
	200		
	250		
	315		
	400		
	500		
	630		
	800		
20	100	26	8.0
	125		
	160		
	200		
	250		
	315		
	400		
	500		
	630		
	800		
1000			
25	100	32	10
	125		
	160		
	200		
	250		
	315		
	400		
	500		
	630		
	800		
1000			

d1	l	d2	k
7.5	100	12	5.0
	125		
	160		
	200		
	250		
	315		
	400		
8.0	100	14	5.0
	125		
	160		
	200		
	250		
	315		
	400		
500			
8.2	100	14	5.0
	160		
	250		
	315		
	400		
8.5	100	14	5.0
	125		
	160		
	200		
	250		
	315		
400			
500			
9.0	100	14	5.0
	125		
	160		
	200		
	250		
	315		
	400		
500			
10	100	16	5.0
	125		
	160		
	200		
	250		
	315		
	400		
	500		
	630		
	800		
1000			
10.2	125	16	5.0
	250		
	315		
10.5	100	16	5.0
	125		
	160		
	200		
11	100	16	5.0
	125		
	160		
	200		
	250		
	315		
	400		
	500		
	630		
	800		
1000			



Code: **SBIAH**

### Ejector Pin - Cylinder Head / ISO 6751, DIN 1530 Form: AH

Material: 1.2516 WS

Head Hardness: 45 ± 2 HRC

Body Hardness: 60 ± 2 HRC

Heat Resistance: 220° max.

Tensile Resistance: 1300 N / mm<sup>2</sup>

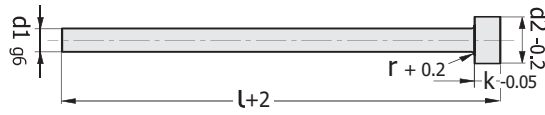

d1	l	d2	k
5.2	100	10	3.0
	200		
5.5	100	10	3.0
	125		
	160		
	200		
	250		
	315		
	400		
500			
6.0	100	12	5.0
	125		
	160		
	200		
	250		
	315		
	400		
	500		
	630		
	800		
1000			
6.2	100	12	5.0
	160		
	250		
6.5	100	12	5.0
	125		
	160		
	200		
	250		
	315		
	400		
	500		
	630		
	800		
1000			
7.0	100	12	5.0
	125		
	160		
	200		
	250		
	315		
	400		
	500		
	630		
	800		
1000			

d1	l	d2	k
3.2	100	6.0	3.0
	160		
3.5	100	7.0	3.0
	125		
	160		
	200		
	250		
	315		
	400		
500			
3.7	100	6.0	3.0
	160		
4.0	100	8.0	3.0
	125		
	160		
	200		
	250		
	315		
	400		
	500		
	630		
	800		
1000			
4.2	100	8.0	3.0
	200		
4.5	100	8.0	3.0
	125		
	160		
	200		
	250		
	315		
	400		
500			
5.0	100	10	3.0
	125		
	160		
	200		
	250		
	315		
	400		
	500		
	630		
	800		
1000			

d1	l	d2	k
1.0	100	2.5	1.2
	125		
	160		
1.2	100	2.5	1.2
	160		
1.3	100	3.0	1.5
	160		
1.4	100	3.0	1.5
	160		
1.5	100	3.0	1.5
	125		
	160		
	200		
1.6	100	3.0	1.5
	160		
1.7	100	3.0	1.5
	160		
1.8	100	3.0	1.5
	160		
1.9	100	3.0	1.5
	160		
2.0	100	4.0	2.0
	125		
	160		
	200		
	250		
	315		
	400		
500			
2.2	100	4.0	2.0
	160		
2.4	100	5.0	2.0
	160		
2.5	100	5.0	2.0
	125		
	160		
	200		
	250		
	315		
400			
2.7	100	5.0	2.0
	160		
	200		
3.0	100	6.0	3.0
	125		
	160		
	200		
	250		
	315		
	400		
500			
630			



Order: **SBIAH**, d1 x l